

NOTES:
 1. DUE TO OUR CONTINUOUS IMPROVEMENT PROGRAM, ALL MODELS AND SPECIFICATIONS ARE SUBJECT TO CHANGE WITHOUT NOTICE.

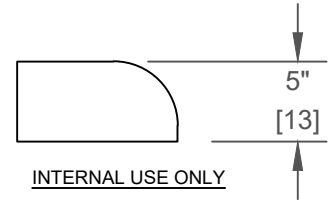
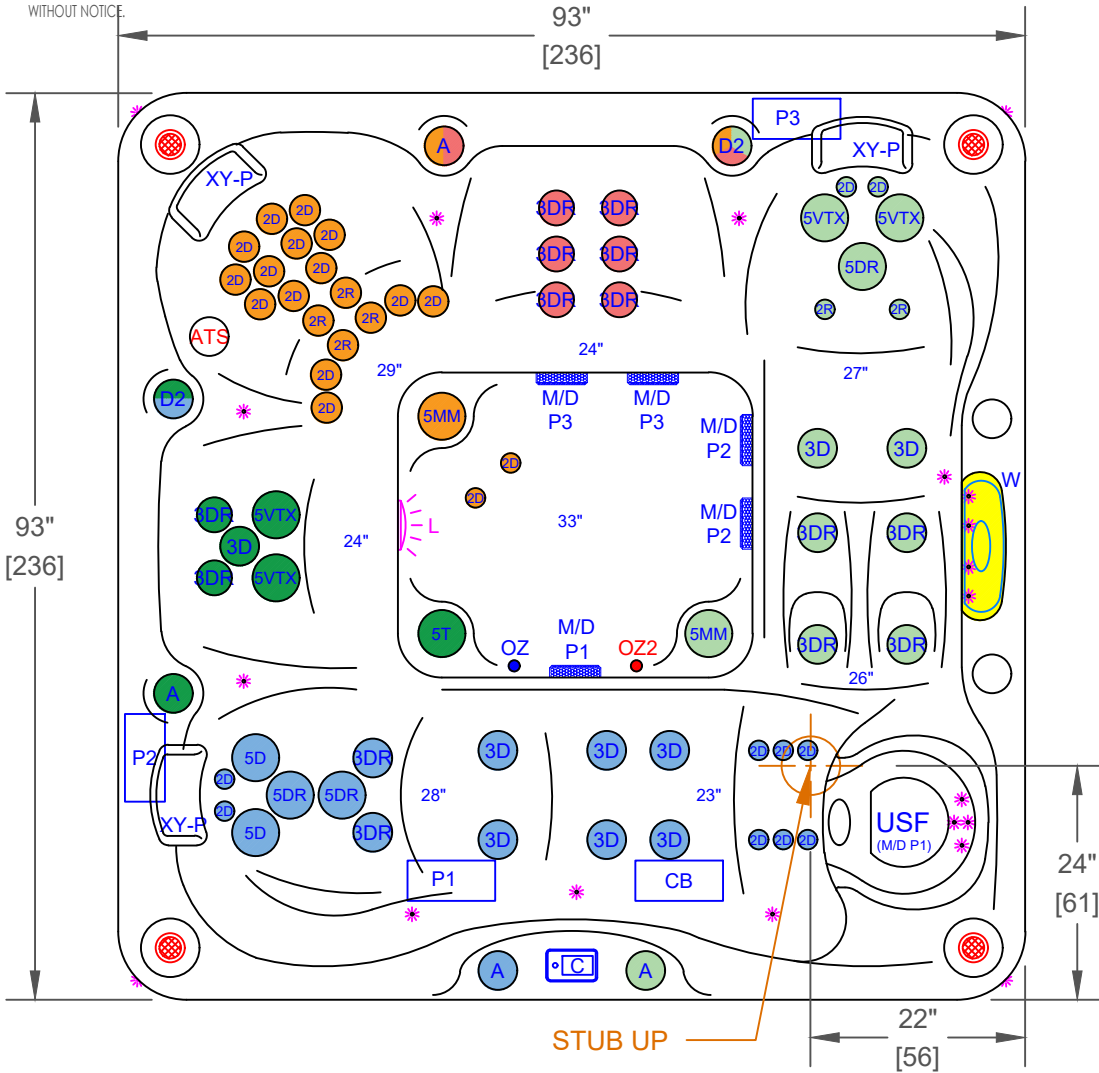

	PUMP 1
	PUMP 2
	PUMP 3
	PUMP 1
	PUMP 2
	PUMP 3
	PUMP 1
	PUMP 2
	PUMP 3
	CONTROL BOX

EC-867DLX - LEGEND

SYMB.	DESCRIPTION	PART NUMBER	QTY.
2D	2" CLUSTER STORM DIRECTIONAL VECTOR X	PLUCS2440019S-HLG	26
2R	2" CLUSTER STORM TWIN VECTOR X	PLUCS2440029S-HLG	6
3D	3" MINI STORM DIRECTIONAL VECTOR X	PLUCS2445009SS-HLG	9
3DR	3" MINI STORM TWISTER VECTOR X	PLUCS2441049S-HLG	14
5D	5" POWER STORM DIRECTIONAL VECTOR X	PLUCS2447009SS-HLG	2
5DR	5" POWER STORM TWISTER VECTOR X	PLUCS2447049SS-HLG	5
5VTX	5" POWER STORM TRI DIRECTIONAL VECTOR X	PLUCS2447019S-HLG	4
5T	5" ADJUSTABLE WHIRLPOOL VECTOR X WITH VALVE	PLUCS2394029S-HLG	1
D2	ORION 2" WATER DIVERTER VALVE	PLUCS600-7609-CDHL	2
A	ORION AIR CONTROL VALVE	PLUCS660-7609-CDHL	4
W	LED WATERFALL		1
USF	75 SQ. FT. ULTRA SKIM FILTER	517-4619LC-HLG	1
M/D	5" MAIN DRAIN 2.5"S	PLU644-5419-HLG V	5
XY-P	TEXTURED Y-PILLOW (WHITE)		3
C	TOUCH CONTROL 1001		1
OZ2	TWIN PURE SILK™ DUAL OZONATOR WITH MAZZIE INJECTORS AND MIXING CHAMBERS		1
	ELITE III SPOTLIGHT 4x CABINET CORNERS LED LIGHTING & STAINLESS STEEL ACCENTS		1
	5" MULTI COLORED LED LIGHT		1
*	PERIMETER LED LIGHTING		1
-	EXTERIOR LED CAL SPAS LOGO		1
-	FILTER LID (SINGLE FLT)	FIL11300260	1

OPTIONS

SYMB.	DESCRIPTION	OPTION NUMBER
-	CAL SPAS THROTTLE SEAT WITH VARIABLE SPEED PUMP	OPT25-108FLX N/A WITH OPT25-113S
ATS	EXCLUSIVE ADJUSTABLE THERAPY SYSTEM PLUS (ATS PLUS)	OPT25-109 N/A WITH OPT25-112C
	TWIN PURE SILK™ DUAL OZONATORS WITH MAZZIE INJECTORS AND MIXING CHAMBERS	OPT25-102DX-1
-	BALBOA EQUIPMENT WITH XL HEATER BP501X w/TOUCH 2 TOPSIDE	OPT25-139BP-3
	CAL SPAS SALT SYSTEM	OPT25-113S
-	PURE CURE UV PURIFICATION SYSTEM	OPT25-191B
	24/7 FILTRATION SYSTEM	OPT25-112C N/A WITH OPT25-109
-	CAL RIDGE CABINET w/SMOOTH CORNERS & LED PERIMETER CABINET LIGHTING	OPT25-983CR-8
-	VICTORY ELITE LED CORNER UPGRADE	OPT25-967VE-0
-	ABS MOLDED BOTTOM TRAY	OPT25-990-8
-	CAL CONNECT RF MODULE	OPT25-168RF
	FREEDOM SOUND SYSTEM BLUETOOTH, POWERED SUBWOOFER AND 4X SPEAKERS	OPT25-FS43
-	THERMO-GUARD FULL FOAM	OPT25-900

PROPRIETARY AND CONFIDENTIAL

THE INFORMATION CONTAINED IN THIS DRAWING IS THE SOLE PROPERTY OF CAL SPAS. ANY REPRODUCTION IN PART OR AS A WHOLE WITHOUT THE WRITTEN PERMISSION OF CAL SPAS IS PROHIBITED.

CalSpa
 CAL SPAS INC.
 1462 EAST NINTH STREET, POMONA, CA 91766

SPECIFICATIONS		TITLE	JET LAYOUT - STD
DIMENSION (in)	93"x93"x40-1/2"	LINE	ESCAPE X-SERIES
DIMENSION (cm)	236x236x100	MODEL	2025 SPA LINE MALIBU
DRY WEIGHT	900 LBS [408 Kg]	NUM	EC-867DLX
FILLED WEIGHT	4650 LBS [2109 Kg]	DWG NO.	CS003375
		REV	B
WATER CAP.	450 GAL [1703 L]	SCALE	NTS
			SHEET 1 OF 1